

PRODUCT TECHNICAL SHEET

Collection : **MEDICO**

Ref. : **4202.--.12**

Mélangeur mural avec bec mobile, flexible, poignée poussoir et support, arrêts incorporés

Wandmengkraan met draaibare uitloop, slang, handdouche met duwer en houder, afsluiters inbegrepen

Wall-mounted mixer tap with swivel spout, flexible, handle with pusher and support, built-in valves

Picture

Product details



Internal mechanism : 1/3 turn compression valve

Technical drawing

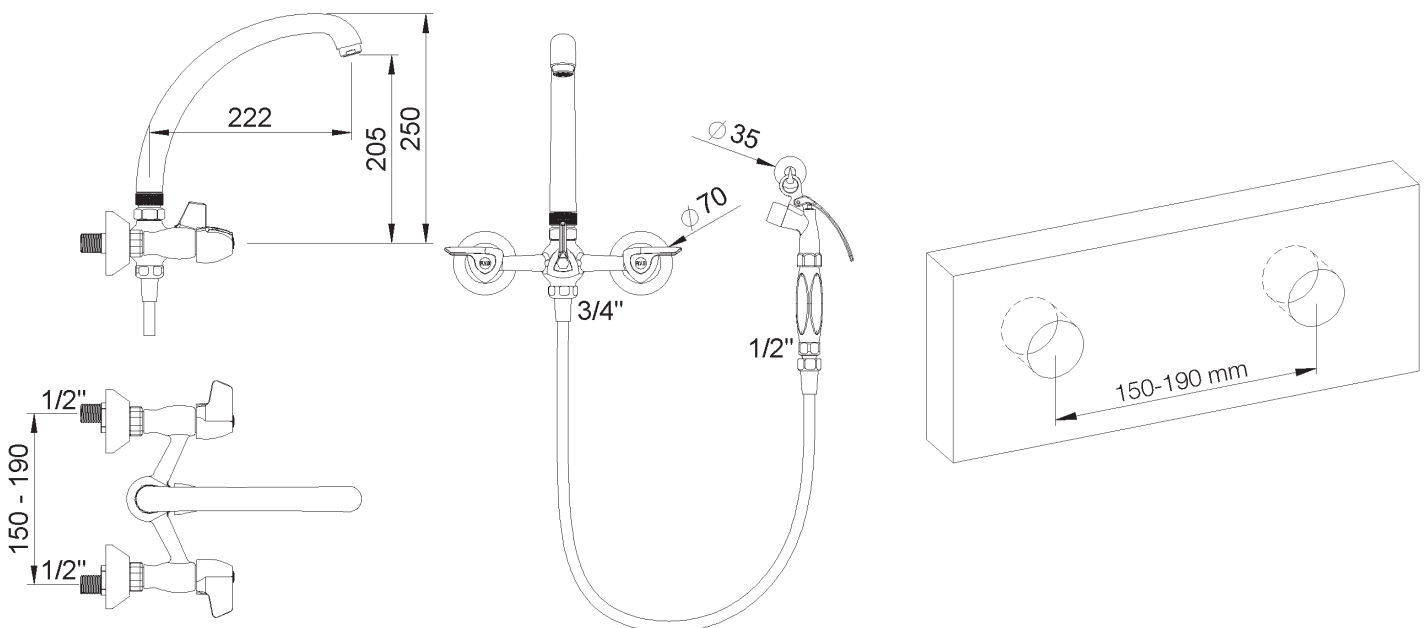

RA0.V01